

NAGASHIMA OHNO & TSUNEMATSU

長島・大野・常松 法律事務所

Access Map (NO&T Tokyo Office)

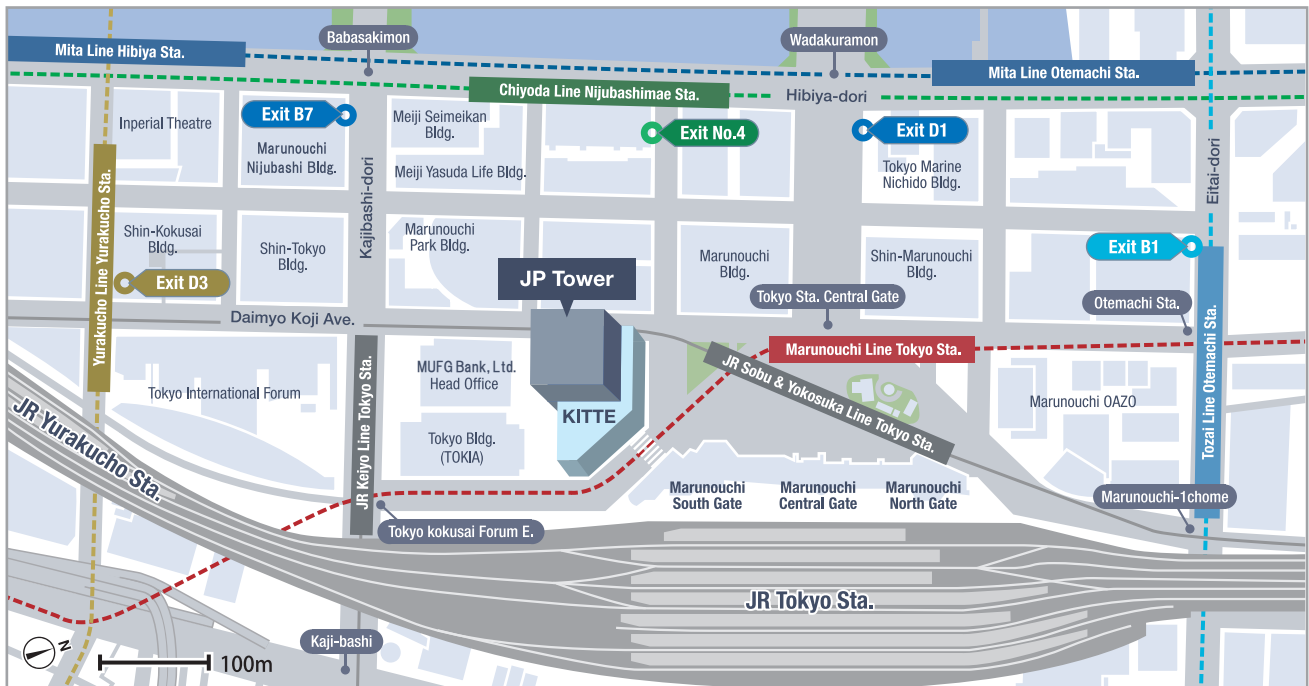

Address

Nagashima Ohno & Tsunematsu

JP Tower, 2-7-2 Marunouchi,
Chiyoda-ku, Tokyo, 100-7036, Japan
(reception 36th floor)

TEL : 81-3-6889-7000 (general)
FAX : 81-3-6889-8000 (general)

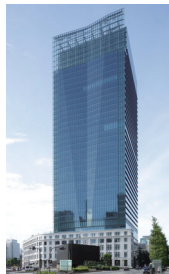

- JR JR Tokyo Sta. (Marunouchi South Gate) - 1-minute walk
- M Tokyo Metro Marunouchi Line, Tokyo Sta.
(direct connection through underground passage from Marunouchi Underground Central Gate / South Gate) - 1-minute walk
- C Tokyo Metro Chiyoda Line, Nijubashimae Sta.
(direct connection through underground passage or Exit 4) - 2-minute walk
- O Tokyo Metro Tozai Line, Otemachi Sta.
(direct connection through underground passage or Exit B1) - 4-minute walk
- M Toei Subway Mita Line, Otemachi Sta. (Exit D1) - 4-minute walk
- M Toei Subway Mita Line, Hibiya Sta. (Exit B7) - 5-minute walk
- Y Tokyo Metro Yurakucho Line, Yurakucho Sta. (Exit D3) - 6-minute walk

Guide to Office Entrance (JP Tower 1st floor)

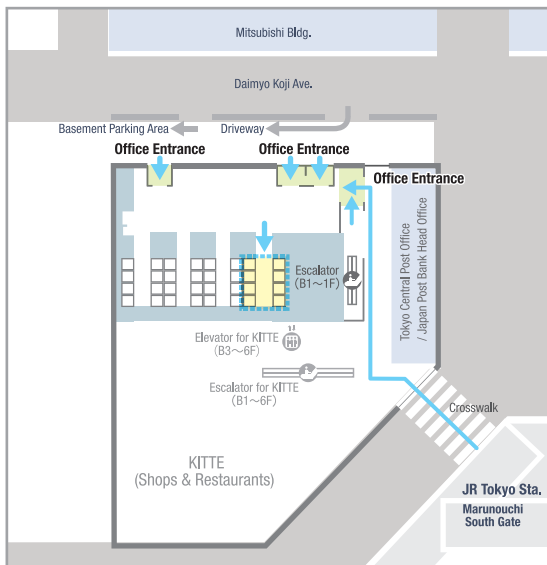

Access by Train/Subway

Please enter through the Office Entrance on the 1st floor.
(Note that the elevators and escalators in KITTE (shops and restaurants) do not connect with the building's office tower).

Access by Car

Please enter through the driveway from Daimyo Koji Ave.
You may use the basement parking area on levels B2 and B3 (payment required).